

Jonathan Hunt

ESTATE AGENCY

20 High Street Ware SG12 9BX

Tel: 01920 411090

8 High Street Buntingford SG9 9AG

Tel: 01763 272727

info@jonathan-hunt.co.uk

www.jonathanhunt.co.uk



Flat 54, Stewart Place Station Road, Ware, SG12 9UN

£275,000

JONATHAN HUNT are pleased to offer this TWO BEDROOM FIRST FLOOR apartment conveniently located close to Ware town centre and Station. The property features a newly installed bathroom suite, double glazed windows and allocated secure parking.

Buntingford Branch - Company No. 10303541 VAT No. 10303541

Ware Branch - Company No. 4759215 VAT No. 700174975

Flat 54, Stewart Place Station Road, Ware, SG12 9UN

ENTRANCE HALL

LIVING ROOM 14'2" x 11'11" (4.34 x 3.64)



BEDROOM TWO 9'10" x 7'8" (3 x 2.34)



REFITTED BATHROOM



KITCHEN 10'2" x 7'2" (3.1 x 2.2)



EXTERIOR



BEDROOM ONE 12'3" x 9'10" (3.75 x 3)



Flat 54, Stewart Place Station Road, Ware, SG12 9UN

ALLOCATED PARKING

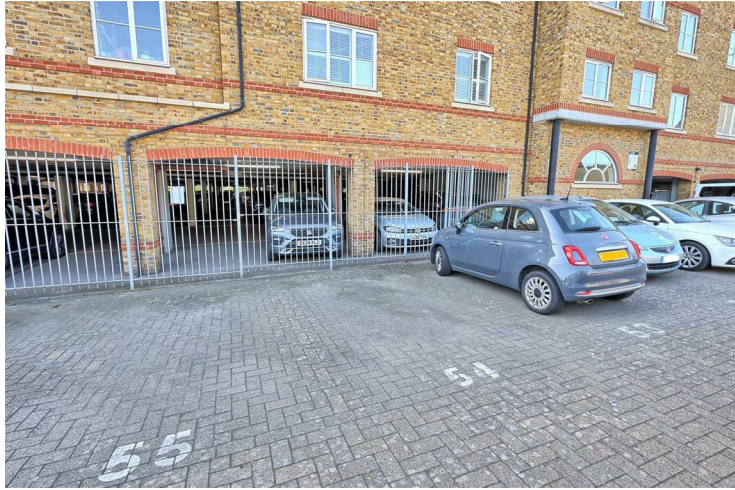

LIFT ACCESS

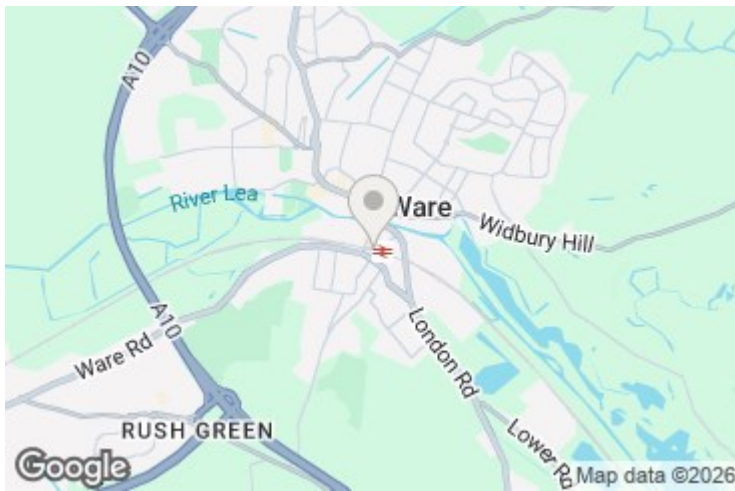

Energy Efficiency Rating		
	Current	Potential
Very energy efficient - lower running costs		
(92 plus) A		
(81-91) B		
(69-80) C		
(55-68) D		
(39-54) E		
(21-38) F		
(1-20) G		
Not energy efficient - higher running costs		
England & Wales	EU Directive 2002/91/EC	

Environmental Impact (CO ₂) Rating		
	Current	Potential
Very environmentally friendly - lower CO ₂ emissions		
(92 plus) A		
(81-91) B		
(69-80) C		
(55-68) D		
(39-54) E		
(21-38) F		
(1-20) G		
Not environmentally friendly - higher CO ₂ emissions		
England & Wales	EU Directive 2002/91/EC	

Approx. 53.4 sq. metres (575.2 sq. feet)

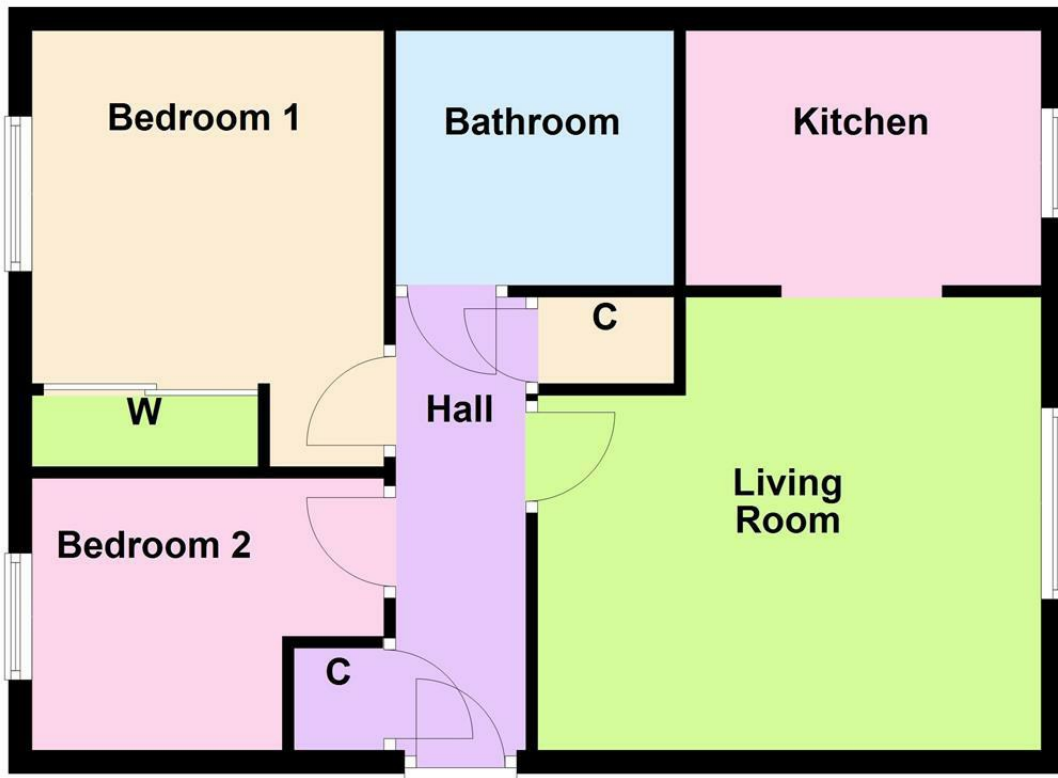

Total area: approx. 53.4 sq. metres (575.2 sq. feet)

Whilst every attempt has been made to ensure the accuracy of the floor plan contained here, measurements of doors, windows, rooms and any other item are approximate and no responsibility is taken for any error, omission, or misstatement. This plan is for illustrative purposes only and should only be used as such by any prospective purchaser.

Plan produced using PlanUp.